



# ENCOM AMERICA, INC.

## OWNER'S MANUAL



MODEL MP45 and MP9  
SEMI-AUTOMATIC PISTOLS AND RIFLES  
45 ACP AND 9 MM

### **WARNING:**

DO NOT LOAD OR OPERATE THIS FIREARM BEFORE READING ALL THE INSTRUCTION MATERIAL.

## WARNING:

1. Do not store the firearm with a cartridge in the chamber. Always treat a firearm as if it is loaded.
2. Never point the firearm at anything that is not your intended target even if the gun is unloaded.
3. Always keep the safety in the safe position (visible red ring on safety button indicates the safety is off and the gun is ready to fire) and be sure the chamber is unloaded until you are ready to fire.
4. Before handling the firearm remove the magazine and retract the slide to unload any ammunition. Never assume the firearm is unloaded.
5. Do not touch the trigger when working with the bolt handle. Never place your fingers on the trigger unless you are ready to shoot.
6. Always use magazines manufactured by Encom America, Inc.
7. Never take medication, drugs or drink alcohol when handling firearms.
8. Never store a firearm loaded.
9. Do not try to alter the sear engagement or trigger pull.
10. Keep all firearms and ammunition beyond the reach of children.
11. Keep barrel pointing towards the ground when loading and unloading any firearm.
12. Always wear shooting glasses for eye protection and ear protectors against the loud report.
13. Only load the firearm immediately before shooting.
14. Never shoot at hard flat surfaces, water surfaces or any surface that can result in a ricochet.
15. Use recommended ammunition. Never use old ammunition and be sure to use the correct cartridge.
16. If the gun fails to fire after pulling the trigger, keep it pointed at target for at least 30 seconds. Sometimes the primer will take longer to ignite properly and cause a "hang fire." The cartridge will fire after a short pause.
17. Never pull the gun towards you by the muzzle. Never climb a tree, cross a fence, or ditch, or run with a loaded gun.
18. Before shooting be sure the gun is unloaded and the barrel is clear of obstruction.
19. Before shooting make sure there is no one in front or to either side of the shooter or no closer than 10 feet behind the shooter.
20. Never keep a loaded gun in a car, boat, home or R.V.
21. Be careful of your backstop and what is behind and to the side of it before you shoot.
22. Keep your firearm cleaned, properly oiled and in good working order.
23. If you have questions concerning the safe operation of the Encom MP-45, please contact Encom America, Inc. before using the firearm.

## A WORD TO THE WISE

Most gun accidents happen because the shooter carelessly violates the single most important rule of safe gun handling:

**ALWAYS KEEP THE MUZZLE POINTED IN A SAFE DIRECTION!**

## LOADING AND FIRING INSTRUCTIONS:

1. Before loading be sure the safety is in the safe position. **WARNING:** Never rely on a gun safety alone. A safety is only mechanical device and is not fail-safe. There is no substitute for caution and common sense.
2. Load the magazine with up to 10 cartridges by pressing the cartridges between the magazine lips.
3. Insert the loaded magazine into the magazine housing with the bolt in the forward position and the finger away from the trigger. Make sure that the magazine is locked into position.
4. To load the chamber point the muzzle towards the ground and pull the bolt handle to the rear and release. This action will pick up a live cartridge from the magazine and load it into the chamber.
5. The Encom MP is now loaded and ready to fire. To fire push the safety button to the "off" position (indicated by visible red ring on safety button) and squeeze the trigger. The pistol will fire semi-automatically with every squeeze of the trigger until the magazine is empty.

## UNLOADING INSTRUCTIONS:

1. Make sure the safety is in the safe position.
2. Keeping your fingers away from the trigger press the magazine catch button and remove the magazine.
3. Keep the safety button to the safe position (when the red ring cannot be seen on the safety button). Grip the bolt handle and pull completely to the rear. This will extract and eject any live cartridge that is chambered. Check the chamber to make sure it is empty.

## MP-45 DISASSEMBLY INSTRUCTIONS

1. Remove the magazine and check to be sure the chamber is unloaded.
2. Unscrew the barrel, counterclockwise, and remove.
3. With the gun pointed down, slide the bolt handle forward to the front end of the slot and pull out the bolt handle. Slide the bolt assembly forward and out of the receiver.
4. To reassemble, be sure the ejector is in the folded down position. Install the parts in reverse order of above.

**NOTE:** The gun can not be assembled with the magazine in the gun.

## MP-9 DISASSEMBLY INSTRUCTIONS

Disassembly of the MP-9 is identical to the MP-45 except that the ejector is located in the lower receiver, just ahead of the trigger guard. The ejector can be folded down, to reinstall the bolt, by pulling back on magazine catch.

**(NOTE:** magazine must be removed for assembly and disassembly)

## DISASSEMBLY INSTRUCTIONS FOR 9MM & .45 RIFLES

1. Remove the magazine and check to be sure the chamber is empty.
2. Unscrew the back plug, counterclockwise, and remove.
3. With the gun pointed up pull the bolt handle to the rear end of the bolt handle slot and pull and then lift it out through the enlarged hole. The bolt assembly can now be pulled out of the receiver.
4. To reassemble, install the parts in the reverse order of above. **NOTE:** be sure to reinstall buffer disk before replacing back plug.

### TECHNICAL SPECIFICATIONS

MODE OF OPERATION	Right or Left Hand Models Available
TYPE	Semi-Automatic Assault Pistol
MODEL	MP-45, MP-9
MANUFACTURER	Encom America, Inc.
CALIBER	45ACP, 9MM
OPERATION PRINCIPLE	Blowback, Closed Breech with Floating Firing Pin
MAGAZINE	Staggered Box Type Holding 10, 30, 40 or 50 rounds
SAFETY SYSTEMS	Push Thru Safety Shotgun Style
SIGHTS	Front: Post Type Rear: Fixed Partridge
STOCK	Optional Retractable with 18½" Barrel
WEIGHT-UNLOADED	6 lbs.
LENGTH	11.8 Inches with 4.5" Barrel
BARREL LENGTH	Optional
NUMBER OF LANDS & GROOVES	6 Right Hand Twish 1 Turn in 18
MUZZLE VELOCITY	Approximately
BREAK DOWN	Four Piece Modular Construction
FINISH	Parkarized

### AMMUNITION

The Encom MP-45 uses the combat proven 45 ACP ammunition. The MP-45 has been test fired and factory tuned to the National cartridge 230gr. full metal jacket and the Winchester 230gr. full metal jacket military specification ammunition. Do not use hot loads, high velocity ammunition, military surplus or any high pressure ammunition (factory or handloaded). The Encom MP-9 is factory tuned to the Winchester 115gr. full metal Jacket military specification ammunition.

### CARE AND CLEANING

To ensure proper functioning, the Encom MP should be disassembled and cleaned at reasonably frequent intervals, preferably always after shooting. Use a good commercial solvent and lubricate with a lightweight gun oil. While cleaning, always point muzzle in a safe direction and keep ammunition far away.

### LIMITED WARRANTY

Handguns manufactured by Encom America, Inc. are warranted to the original retail purchaser to be free from defects in material and workmanship. Any such defect should be reported to Encom America, Inc. by written notice and will be remedied by Encom America, Inc. without charge.

Warranty claims (in writing) and the gun concerned should be directed (transportation charges prepaid) to Encom America, Inc. Service and Warranty Center, 2571 Morgan Road Marietta, Georgia 30066. Warranty claims should state the model and serial number of the gun concerned, a description of the difficulty experienced, and the date, place and proof of purchase. It is recommended that shipments be insured by owner, since Encom America, Inc. will accept no responsibility for loss or damage in transit.

**UNDER NO CIRCUMSTANCES SHALL ENCOM AMERICA, INC. BE RESPONSIBLE FOR INCIDENTAL OR CONSEQUENTIAL DAMAGES WITH RESPECT TO ECONOMIC LOSS OR INJURY TO PROPERTY, WHETHER AS A RESULT OF BREACH OF EXPRESS OR LIMITED WARRANTY, NEGLIGENCE OR OTHERWISE.**

**ENCOM AMERICA, INC. WILL NOT BE RESPONSIBLE FOR THE RESULTS OF ABUSE, CARELESS HANDLING, UNAUTHORIZED ADJUSTMENTS AND/OR MODIFICATIONS, DEFECTIVE OR IMPROPER AMMUNITION, CORROSION, NEGLIGENCE, ORDINARY WEAR AND TEAR, OR UNREASONABLE OR UNAUTHORIZED USE.**

**PLEASE NOTE:** Handguns are classified as FIREARMS or DANGEROUS WEAPONS. Guns are surrendered by Encom America, Inc. with the express understanding that it assumes no responsibility for resale or safe handling under local laws and regulations.

### "THE ENCOM LIFETIME REPAIR POLICY"

Without extending our normal warranty, we will repair, free of charge, any weapon manufactured or distributed by Encom America, Inc. Enclose a check or money order in the amount of \$7.00 for transportation and insurance charge for return of repaired firearm or return will be freight, COD.

EXECUTIVE OFFICES:  
P.O. Box 5314, Atlanta, Georgia 30307

SERVICE AND WARRANTY CENTER  
2571 Morgan Road, Marietta, Georgia 30066

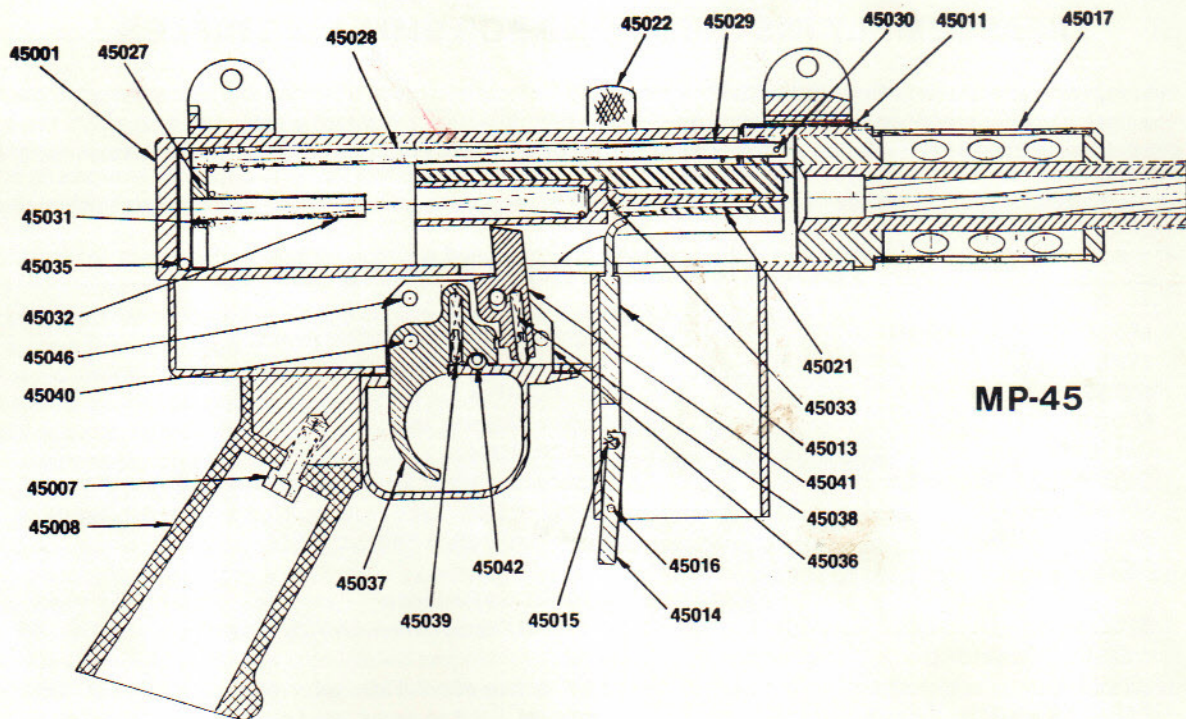

**MP-45**

**ILLUSTRATED PARTS LIST**

PART NO.	ITEM	PART NO.	ITEM	PART NO.	ITEM
45001	Receiver Assembly	45024	Extractor	45036	Trigger Housing
45007	Grip Screw	45025	Extractor Spring	45037	Trigger
45008	Grip	45026	Extractor Pin	45038	Trigger/Sear Spring (2 per gun)
45011	Barrel Retainer Spring	45027	Recoil Spring Plate	45039	Trigger/Sear Plunger (2 per gun)
45013	Ejector	45028	Recoil Spring Guide	45040	Trigger Pin (3 per gun)
45014	Magazine Catch	45029	Recoil Spring	45041	Sear
45015	Magazine Catch Spring	45030	Recoil Spring Guide Pin	45042	Safety
45016	Magazine Catch Pin	45031	Firing Pin Spring	45043	Safety Detent
45017	Barrel Assembly	45032	Firing Pin Spring Guide	45044	Safety Detent Spring
45021	Bolt	45033	Firing Pin	45045	Safety Detent Screw
45022	Bolt Handle	45035	Buffer Disk	45046	Trigger Assembly Pin

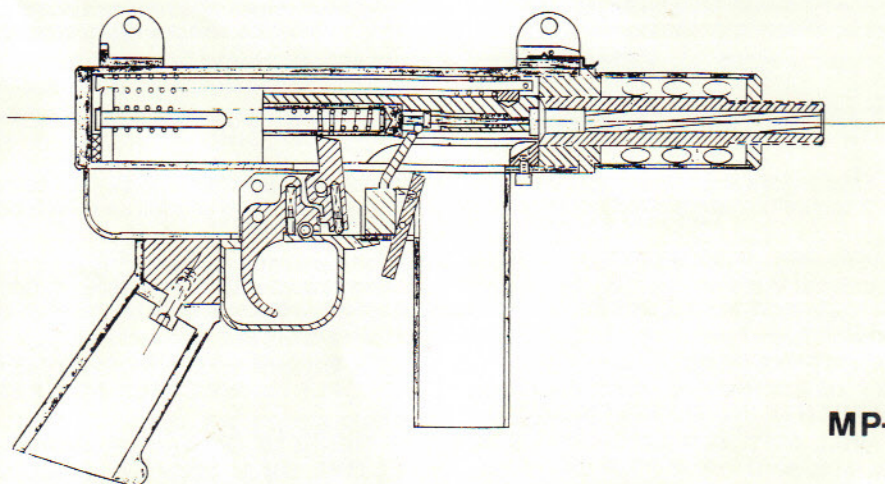

**MP-9**

**SPECIAL NOTE**

A ring or what appears to be a crack can be seen on the rear of the barrel, around the chamber feed cone, this is a thread joint between the barrel and barrel ring. This is a normal condition and no cause for alarm.

When removing the bolt assembly do not use excess force as the spring guide rod can be bent or broken.

When installing the bolt assembly be sure the ejector is folded down, as trying to force the bolt in with the ejector up can cause damage to it.

The use of a magazine loader prevents the magazine lips from spreading which will cause jamming.